

Delivery to AES by: ASAP

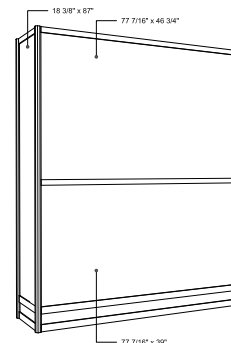

**Lightbox
Unit
H200**

**Qty: 2
18-3/8" x 87"**

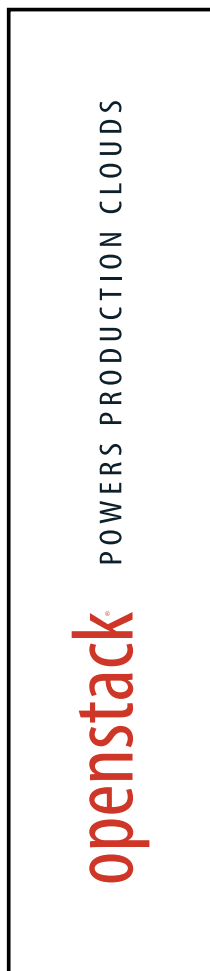

**Qty: 2
77-7/16" x 46-3/4"**

**Qty: 2
77-7/16" x 39"**

JOB NAME	Open Stack 2M Lt. Box Unit			
Size				
Quantity	1 Unit (6 panels)	<input checked="" type="checkbox"/> single-sided	<input type="checkbox"/> double-sided	<input type="checkbox"/> Velcro <input type="checkbox"/> Grommets
Substrate	<input type="checkbox"/> Foamcore <input type="checkbox"/> 3/16" <input type="checkbox"/> 1/2" <input checked="" type="checkbox"/> Milk Plex <input type="checkbox"/> 1mm <input checked="" type="checkbox"/> 3mm <input type="checkbox"/> Sintra <input type="checkbox"/> 1mm <input type="checkbox"/> 3mm <input type="checkbox"/> EcoTrans <input type="checkbox"/> 1/8" <input type="checkbox"/> 3/16"	<input type="checkbox"/> White <input type="checkbox"/> Black <input type="checkbox"/> Other	<input type="checkbox"/> Pole Pockets <input checked="" type="checkbox"/> Back-Lit	

VERSIONS			
V1	10/22/12	V2	10/26/12
V3		V4	

CLIENT APPROVAL	
INITIALS	
DATE	